



E660 grill with new Side Handle Kit

OVEN HOOD SIDE HANDLE KIT

A new **Oven Hood Side Handle Kit** has been created to make Fire Magic and AOG gas grill oven hoods more accessible for disabled users. The new handle, combined with other specifications such as installed height of a built-in or post mounted grill, may comply with ADA guidelines (check local requirements).

The sturdy design requires some field assembly and drilling. All necessary components are provided for installation on the left or right-hand side of the oven hood and a drill bit and template are included. See complete installation details in the attached instructions.

The handle is especially effective when used with Fire Magic Echelon Diamond and Aurora grills which feature featherlight, easy lift oven hoods. A spring kit (#23729-71) may be added to Choice grills to upgrade with this feature (not available for AOG).

The Fire Magic/AOG Oven Hood Side Handle Kit is now available. Order **Model No. 3600-50** with a **list price of \$55**.

The kit may be added to the following models:

GRILL SERIES	MODEL
Echelon Diamond	E660, E790, E1060
Aurora	A430, A530, A540, A660, A790
Choice	C430, C530
AOG "L" Series	24, 30, 36
AOG "T" Series	24, 30, 36

FIRE MAGIC / AOG

Oven Hood Side Handle Kit

Model # 3600-50

INSTALLER: Leave these instructions with consumer.
CONSUMER: Retain for future reference.

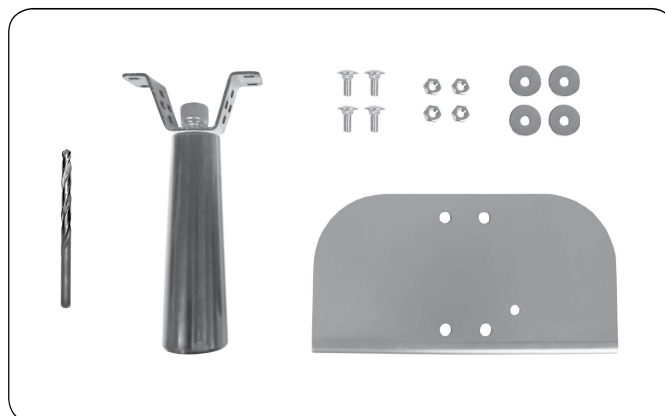

IMPORTANT: READ THESE INSTRUCTIONS CAREFULLY BEFORE STARTING INSTALLATION OR USE.

This Oven Hood Side Handle Kit is an add-on to the compatible grill models listed below:

Grill Series	Model
Diamond Series	E660, E790, E1060
Aurora Series	A430, A530, A540, A660, A790
Choice Series	C430 *, C540 *
AOG "L" Series	24, 30, 36
AOG "T" Series	24, 30, 36

* See Important information below.

Table 1 - Compatibility chart

Important: Choice Grills require oven hood to be upgraded with a spring kit (#23729-71) to use this side handle kit. See reverse side for more information.

The oven hood side handle kit may be installed on the left or right side of the grill oven hood. Left installation shown here.

1. Be sure the unit is completely cool, the control knobs are turned to the OFF position, the gas supply is shut off, the light switch is off (if equipped), and the power supply is disconnected (if applicable).
2. Open oven hood and place the stainless steel drilling template onto the oven hood as shown in Fig. 1-1. Ensure the template is fully pressed against the hood side bottom flange and against the top corner of hood.

Note: Optional - Use a grip/clamp to hold the template in place to assist while drilling.

3. Using the provided drill bit, drill the four (4) holes through the oven hood side wall as shown in Fig. 1-2. Then remove the template.
4. Align the bracket to the holes on the oven hood and fasten the handle kit using the supplied screws, washers, and nuts (see Fig. 1-3).

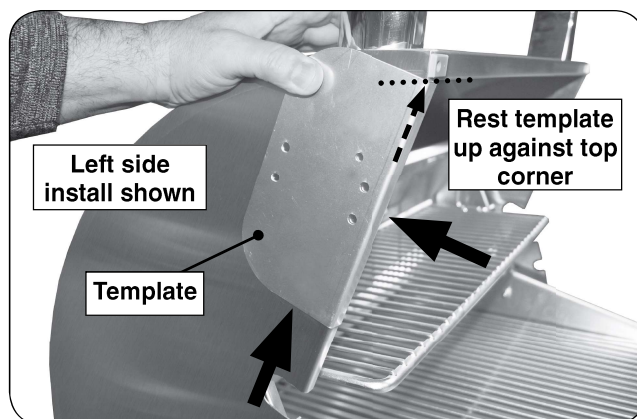

Fig. 1-1 Place drilling template (on hood)

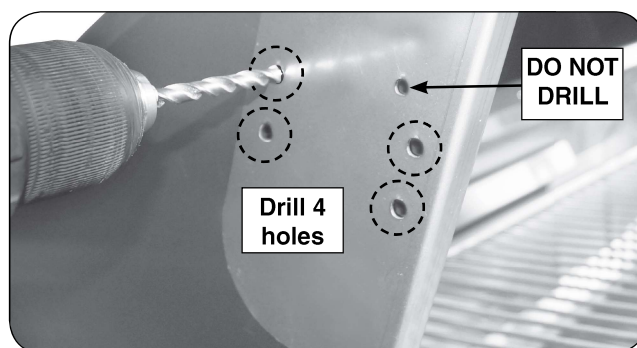

Fig. 1-2 Drill holes (on hood)

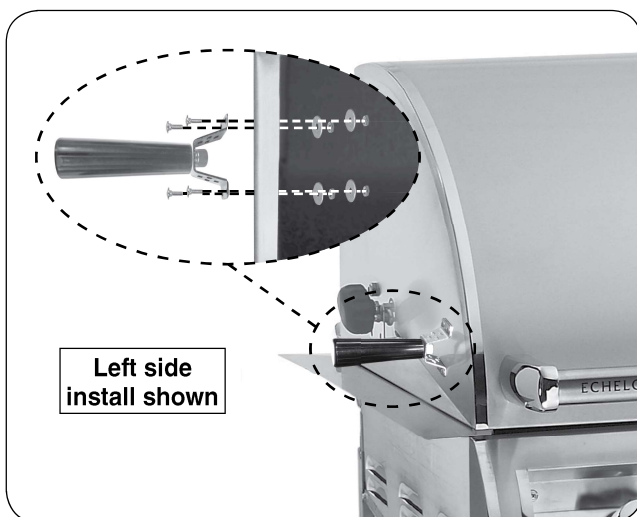

Fig. 1-3 Install bracket to hood

CHOICE GRILL INSTALLATION (if applicable)

Important: Choice Grill oven hoods **MUST** be upgraded with an Oven Hood Spring Kit (#23729-71) **BEFORE THE OVEN HOOD SIDE HANDLE KIT CAN BE INSTALLED.** See Fig. 2-1 and contact your local dealer for ordering information.

SPRING KIT INSTALLATION (purchased separately)

1. Be sure the unit is completely cool, the control knobs are turned to the OFF position, the gas supply is shut off, and the warming rack is removed.
2. Remove oven hood bolts and nuts from both sides as shown in Fig. 2-2, A.
3. **Using two installers**, carefully lift the oven hood from the grill and remove completely (Fig. 2-2, B). Rest the hood (on it's side) on a soft surface.

Note: Be careful with the spacers while the hood is being removed. Remove the spacers once the hood is completely freed from the grill. Reference Fig. 2-2.

4. With the oven hood removed and set aside, place the stainless steel drilling template onto the base oven side wall as shown in Fig. 2-3.

5. Using a .195" drill bit (**not included**), drill a hole through the base oven side wall as shown in Fig. 2-4.

Note: This hole will be used to mount the spring.

Installation continued on next page

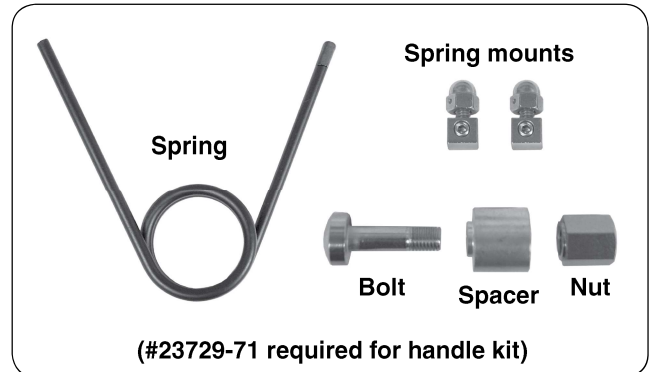

Fig. 2-1 Required spring kit (purchased separately)

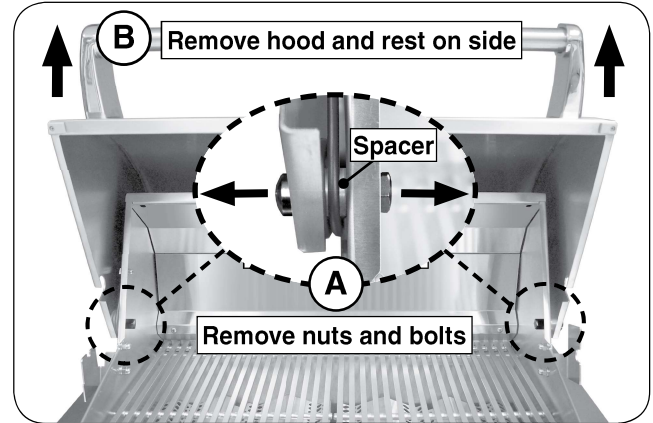

Fig. 2-2 Remove hood

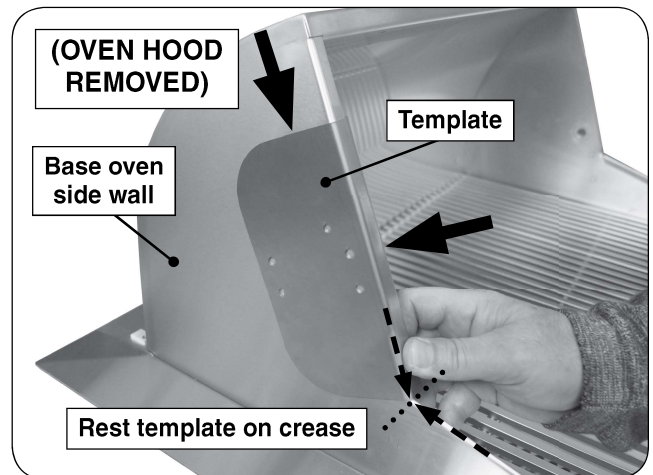

Fig. 2-3 Place drilling template (on oven base)

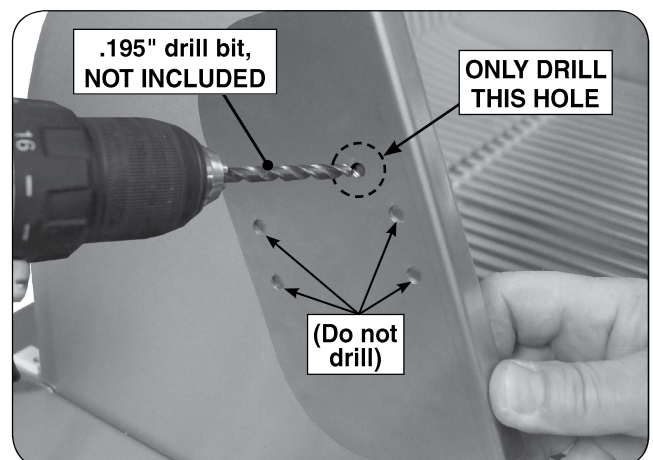

Fig. 2-4 Drill hole for spring mount (on oven base)

CHOICE GRILL INSTALLATION (if applicable) Cont.

6. HOOD: install the new spring and mounting hardware. Ensure the spring is oriented exactly as shown in Fig. 3-1.
7. BASE OVEN SIDE WALL: install the new mounting hardware. Do not fully tighten. Leave slightly loosened to allow some play for the next step. See Fig. 3-2.
8. Ensure the spacers are attached to both sides of the hood cutouts (Fig. 3-3, A), and (using two installers) carefully orient the hood back onto the grill (Fig. 3-3, B). While situating the hood, carefully insert the new spring into the spring mount and secure with an Allen wrench (Fig. 3-3, C).
9. Align the hood, insert the two bolts, and fully secure with nuts as shown in Fig. 3-4.

Note: Ensure notches on nuts are fully inserted into the cutouts to ensure proper alignment before securing.

10. Fully tighten the spring mount from inside the base oven. Reference Fig. 3-2.

The handle kit is now ready for installation. See the first page of this instruction to install the handle kit.

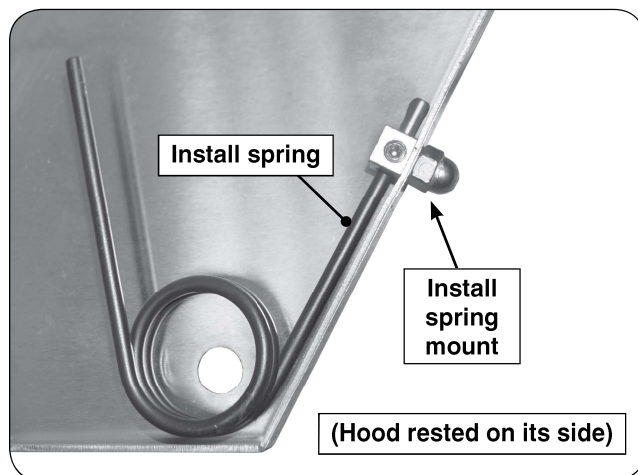

Fig. 3-1 Install spring and spring mount (on hood)

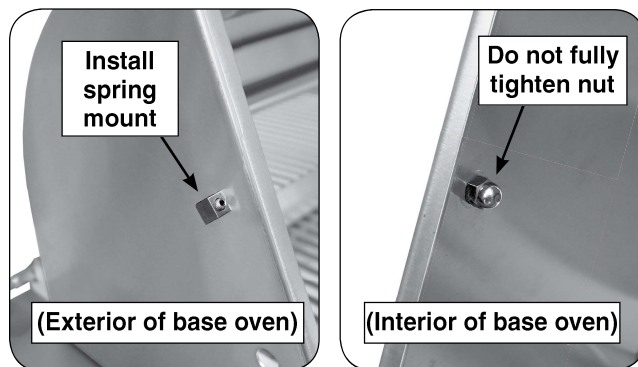

Fig. 3-2 Install spring mount (on base oven)

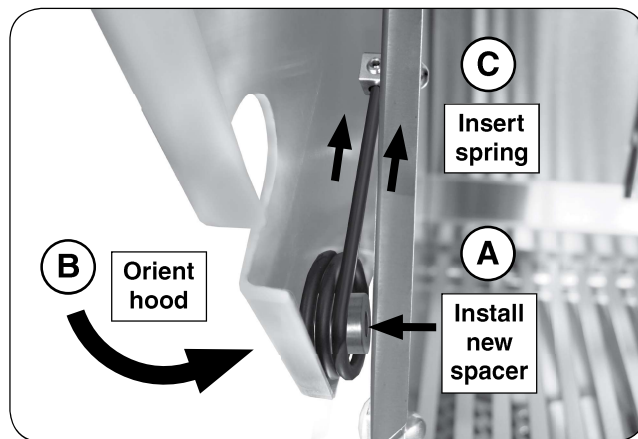

Fig. 3-3 Install hood

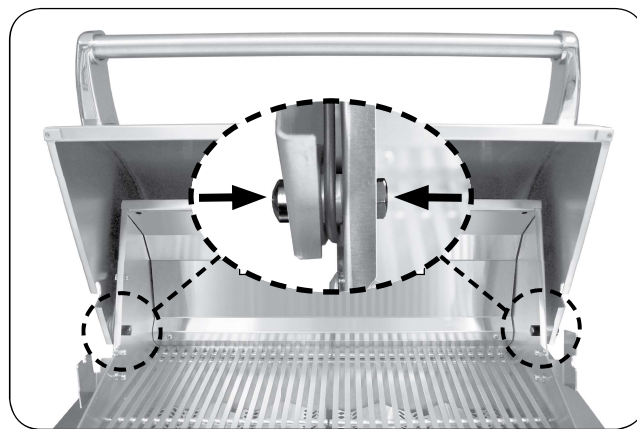

Fig. 3-4 Secure hood with nuts and bolts

Please use this page to record any information that you may want to have at hand.